

Hands on with Entra Suite

inc. ID Governance



Tom Urwin

Senior Architect

Stuart Ogle

Identity Consultant



Agenda

- What's new in Entra?
- Entra Suite overview
- User Journey
- Real-world examples
- Demos
- Your challenges (interactive session)
- Q&A



What's new in Entra?

- Application-Based Authentication for Entra Connect Sync
- Externally determine the approval requirements for an access package using custom extensions
- Revoke all refresh tokens for a user in LCWs
- Configure an application to trust a [user-assigned] managed identity
- Suggested access packages in My Access (now default)
- Conditional Access Optimization Agent
- Entra Agent ID
- TLS Inspection: real-time decryption and inspection of HTTPS traffic

Public
Preview



Entra Suite

- Microsoft Entra Private Access
Securely connect to private resources
- Microsoft Entra Internet Access
Securely access internet and SaaS apps
- Microsoft Entra ID Governance
Advanced governance, workflows and extensibility
- Microsoft Entra ID Protection
Adaptive risk controls
- Microsoft Entra Verified ID (Premium)
Remote onboarding and verification
8x Face Checks per month

Discount for
Entra ID P2
customers



User Journey

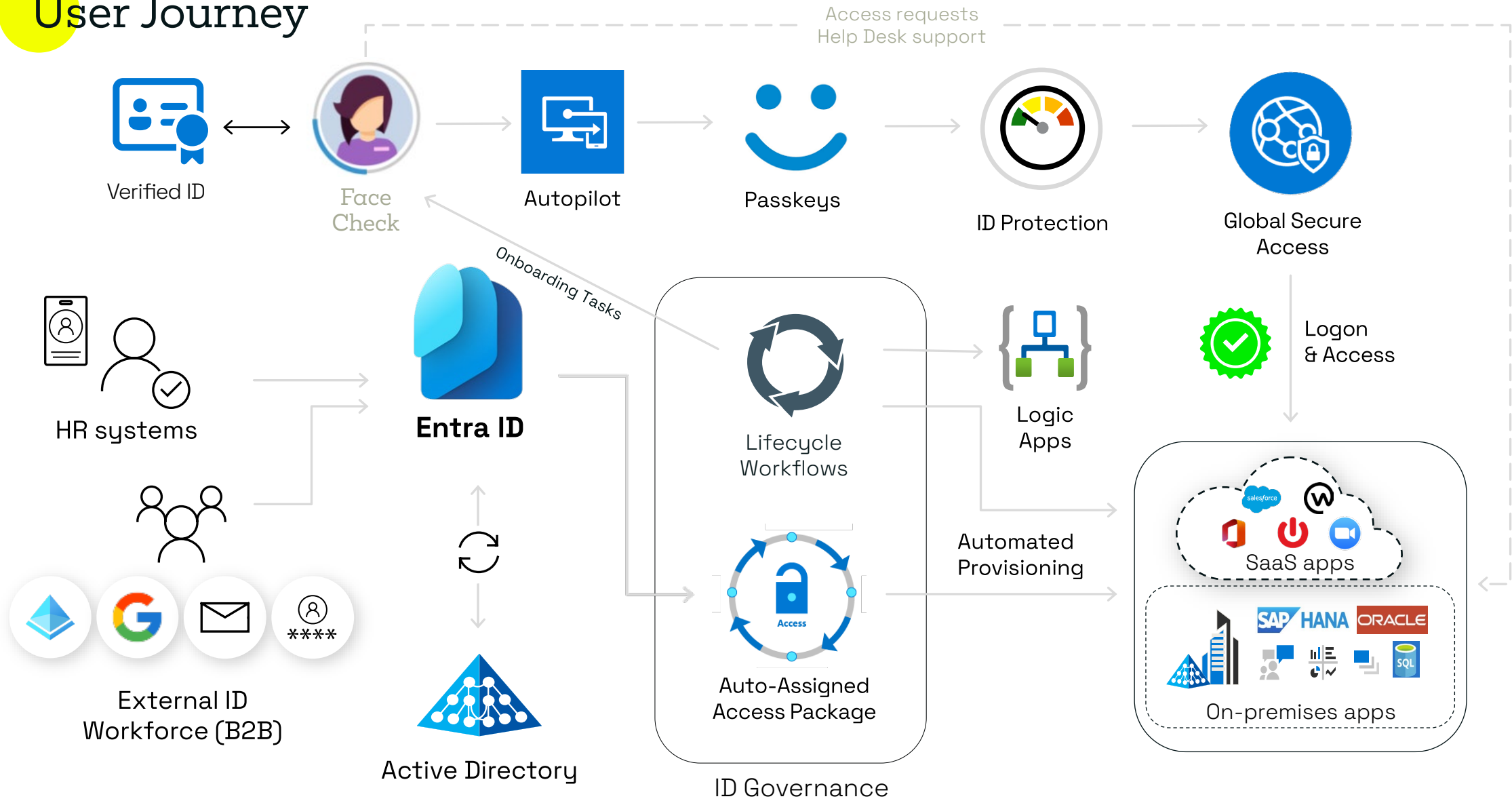

Ongoing Auditing and Reporting

Real-world examples

- Provisioning from *any* authoritative source with pre-processing and post-processing
- Triggering automation events at the right time
- Automatically populating Internet and Private Access groups
- Onboarding guests and automatically provisioning on-premises
- Secondary account lifecycles and just-in-time access to on-premises*
- Signing on to file shares or SSH remotely with MFA*
- Performing a Face Check before gaining privileged access*
- Performing a Face Check before getting served by Help Desk*

* Demo
coming up

